

TWIN LAMP

LED Non-maintained emergency twin light



MTL/NM/L203



MTL/NM/L203 WP

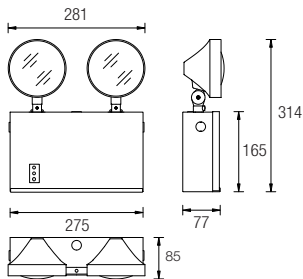

MTL/NM/L203

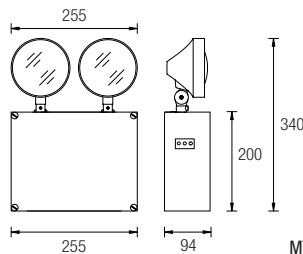

MTL/NM/L203 WP

Dimension: mm NTS
High Power L.E.D
from LUMILEDS

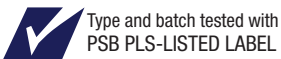

Surface Mount
Wide Angle
Emergency Luminaire



IP30
Can be
upgraded
to IP54
CLASS 1

TECHNICAL DATA

Mode of operation	: Non-Maintained
Lamp	: 2 x 3W High Power LED
Rated duration	: 2 hr and others
Mains supply	: 230 Volts, 50/60Hz
Power consumption	: 2VA
Battery	: Maintenance-free sealed lead calcium battery (High temp nickel cadmium available)
Charge monitor	: Green LED Ø5mm
Test facility	: Micro switch
Safety feature	: Low volt cut-off preventing battery overdischarge
Fitting construction	: Electro galvanised steel with epoxy powder coating The adjustable fire-retardant lamp-heads allow flexibility in angle of projection. Lamp heads comes with anti-glare lens
Mounting	: Wall
Cable entry	: Ø20mm K/O hole
Weight	: 2.7kg (gross)
Compliance	: SS563 : Part 1 & 2, SS 263 : Part 2
Warranty	: 1 year

ORDERING GUIDE

(Please check with Sales Dept if customisation is required)

Model	Lamp	Battery type
MTL/NM/L203	2 x 3W LED	Sealed lead calcium
MTL/NM/L203 NC	2 x 3W LED	Nickel cadmium

Note:

Can be upgraded to IP54  for all weather condition.

MTL/NM/L203 WP and MTL/NM/L203 NC WP  for all weather condition.

KEY FEATURES

- > high brightness output
- > high lumen/watt efficiency
- > low power consumption
- > low maintenance
- > long lifespan